

- NOTE:
1. TRANSFORMER IS FREESTANDING IN ENCLOSURE
 2. METAL GAUGE TO CSA-C22 No. 94-M91
 3. PAINT ASA # 61 GRAY
 4. BOLTED, KNOCK DOWN CONSTRUCTION
 5. OPEN BOTTOM
 6. COVERED OPENING FOR ACCESS TO LIFTING POINTS

CSA TYPE 3R (NEMA 3R)
INDOOR/OUTDOOR USE

APPROX. WEIGHT:
CORE & COIL: 21400 LBS
ENCLOSURE: 1900 LBS
TOTAL: 23300 LBS

TRANSFORMER:

KVA: 2750

PRIMARY VOLTAGE CLASS: 34.5 KV

PRIMARY VOLTAGE: 34500 VOLTS DELTA*
OR
 27600 VOLTS DELTA*

OR
 OTHER _____

2x2.5% FCAN, 2x2.5% FCBN

PRIMARY TAPS:

600V/347 VOLTS

OR
 480V/277 VOLTS

OR
 OTHER _____

OR
 OTHER _____

PRIMARY B.I.L.:

SECONDARY B.I.L.: 150 KV

INSULATION CLASS: 10 KV

TEMPERATURE RISE: 220°C

IMPEDANCE: 150°C

SOUND LEVEL: STANDARD

WINDING MATERIAL:

COPPER

OR
 ALUMINIUM

TERMINAL MATERIAL:

COPPER

OR
 ALUMINIUM

STANDARD FEATURES: ANTI-VIBRATION PADS

VECTOR DIAGRAM

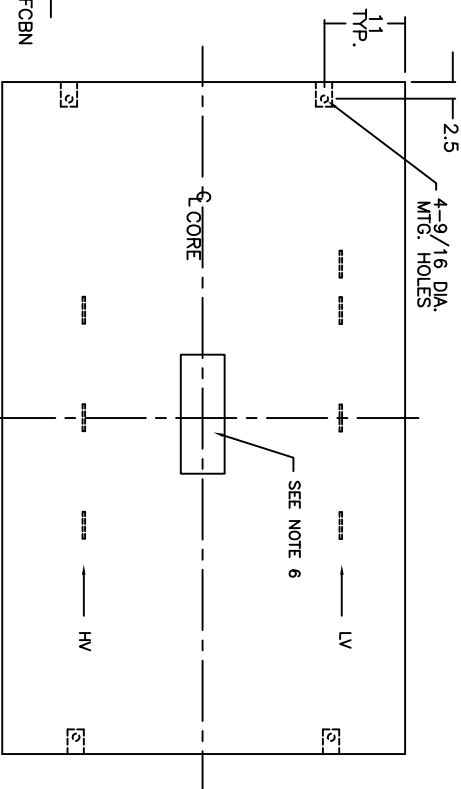
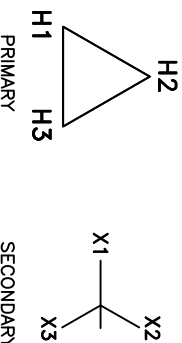

PLAN VIEW
(COVER REMOVED)

① NAME PLATE

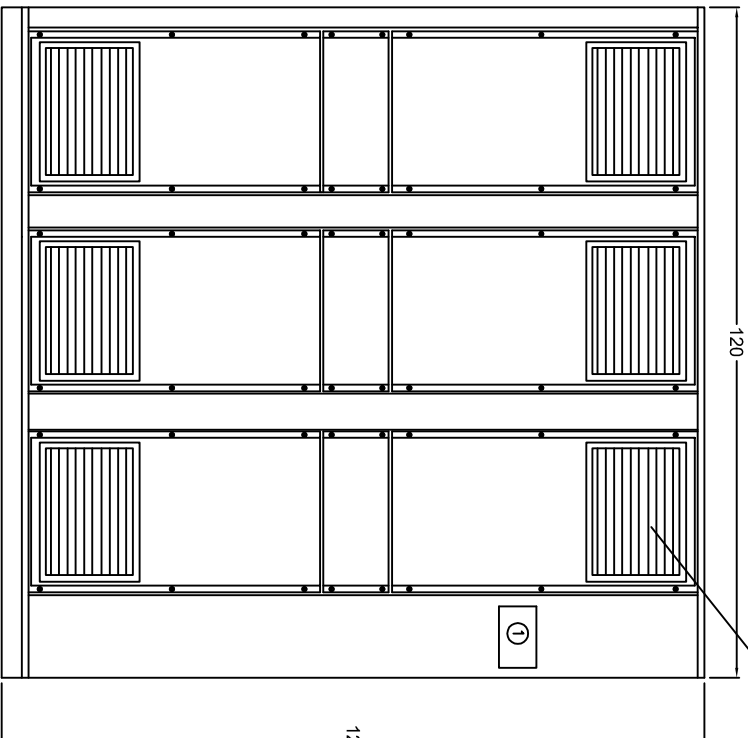

FRONT VIEW

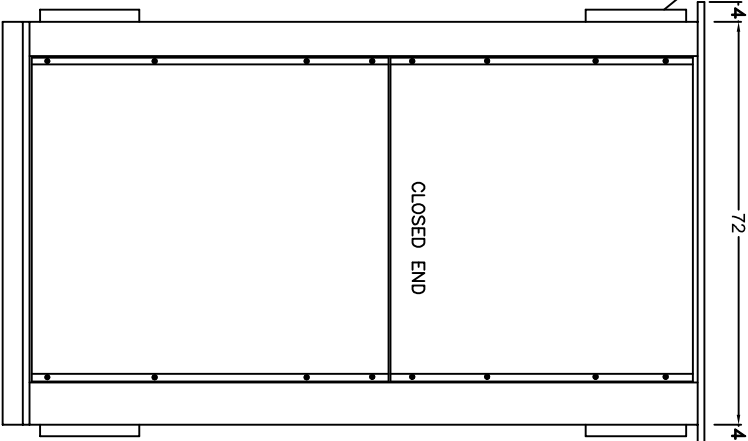

END VIEW

Note: Dimensions may change if units are co-ordinated with switchgear.
Dimensions are estimates. For firm dimensions contact factory.
*For Y-Y connection consult factory for dimensions

REV.	REMARKS	BY	DATE

REX POWER MAGNETICS
DIVISION OF TRANSFACTOR INDUSTRIES INC.

SCALE: N.T.S. DRAWN BY: SARKIS DATE: JUNE 8, 10¹⁹⁸⁶ REV: 0

TITLE: 2750KVA 34.5KV CLASS ENCLOSURE OUTLINE NEMA-3R

DRAWING No. 2750KVA-BIL150-3R