

6 5 4 3 2 1

D

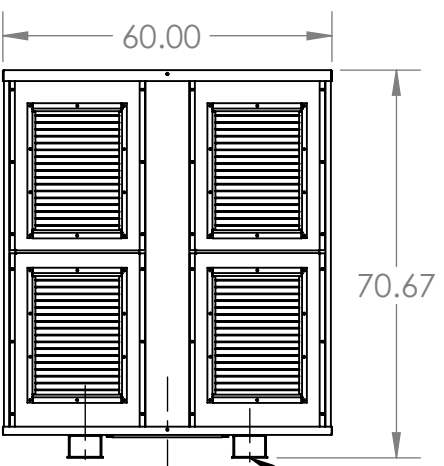

C



B

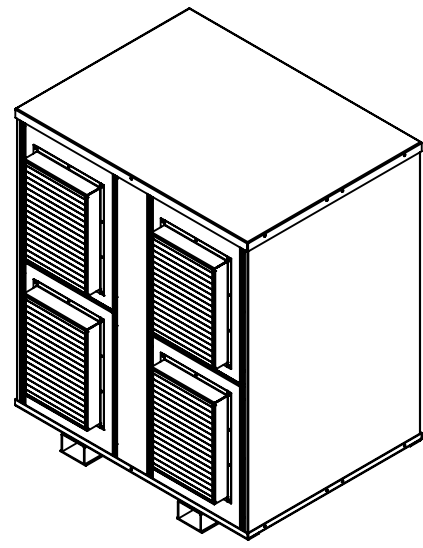
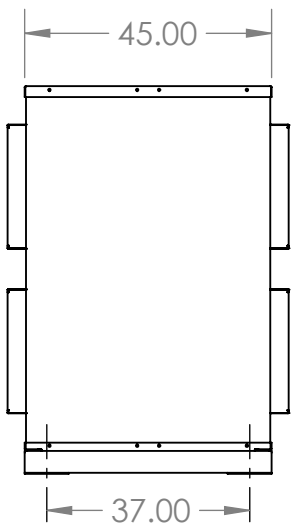
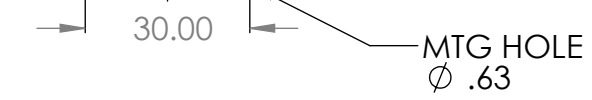

D

C

B

- Note:
1. An air space of not less than 150mm (6 inches) is required between transformer enclosures and between a transformer enclosure and any adjacent surface except floor.
 2. Please ensure that aluminum mesh filter is installed behind each chevron panel.
 3. Adequate ventilation is essential for the proper cooling of transformer. Those filters should be inspected for dust and cleaned to permit free circulation of air.

A

CSA Enclosure: E12-11
 1. Type 12 (NEMA 12)
 2. Ventilated
 3. ASA 61 Grey
 4. Floor mounting
 5. Weight: 734 Lbs

UNLESS OTHERWISE SPECIFIED: DIMENSIONS ARE IN INCHES .XX = ± 0.05" .XXX = ± 0.030" .XXXX = ± 0.005" FRACTIONS = ± 1/16" ANGLES = ± 1°	NAME	DATE	TITLE: STANDARD ENCLOSURE NEMA 12 #11 ASSEMBLY	
	DRAWN	WW		
	APPROVED	VS	9/16/2019	SIZE A DWG. NO. E12-11
	MATERIAL	STEEL		
THE INFORMATION ON THIS DRAWING IS THE PROPERTY OF REX POWER MAGNETICS. IT IS DISCLOSED IN CONFIDENCE AND IS NOT TO BE REPRODUCED, USED OR DISCLOSED EXCEPT FOR THE PURPOSE FOR WHICH FURNISHES.	FINISH	ASA 61 GREY		SCALE: NTS
THIRD-ANGLE PROJECTION	REX POWER MAGNETICS		WEIGHT: 733.18 LBS	SHEET 1 OF 1

A

6 5 4 3 2 1